

EAI INTSYS

6TH EAI INTERNATIONAL CONFERENCE ON INTELLIGENT TRANSPORT SYSTEMS

LISBON, PORTUGAL

15-16th | DEC | 2022



How to Reach Iscte:

Full address

Iscte - Instituto Universitário de Lisboa
Av. das Forças Armadas,
1649-026 Lisboa-Portugal

Coordinates

Latitude: 38.748753

Longitude: -9.153692

The conference will take place at Auditorium Afonso de Barros on the groundfloor of Ala Autónoma Building. If you chose the entrance of Av. das Forças Armadas, it is the first building on your left handside

Lunch will be served at Indeg Building on the roof top.

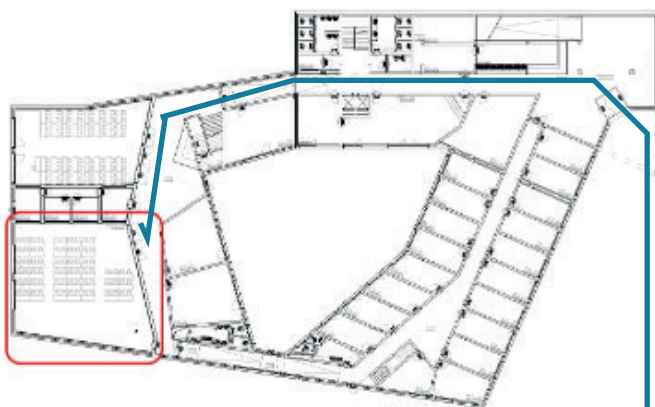
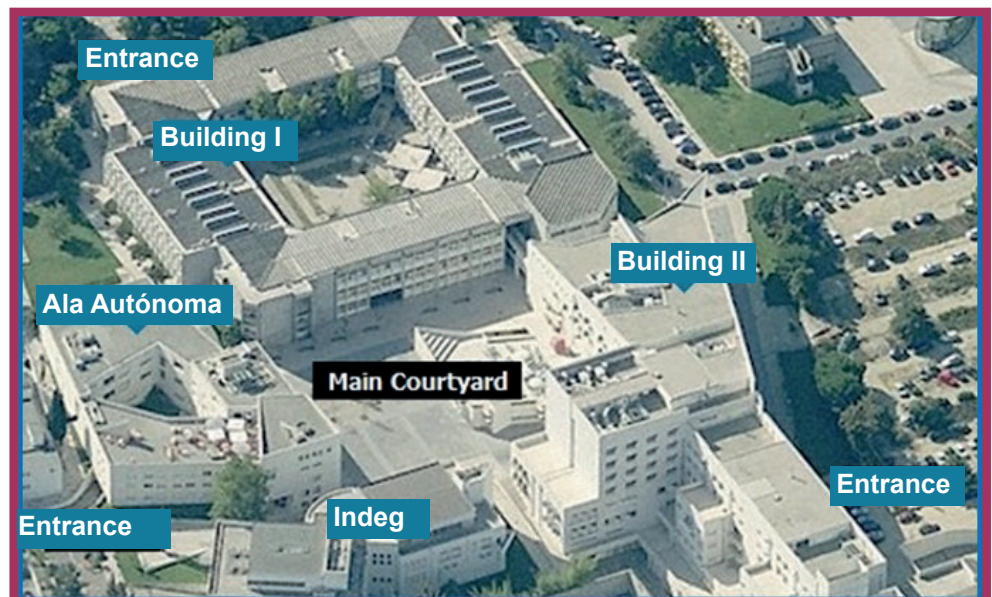

Ala Autónoma
Ground floor Plan

Forças Armadas Avenue

Check-in contact person:

Luís Elvas

+351 969 152 334

Joana Alves

+351 210 464 319

MAP | Airport > Iscte



Flights

Since there are numerous airlines and flights from different cities across the globe to Lisbon airport (LIS), we have not arranged with a particular travel agency for flights to Lisbon. Good deals can be found online or through different airlines (e.g., EasyJet, Ryanair, TAP, Air France, British Airways, etc.).

Lisbon Airport is the main international gateway to Portugal. It is one of the few airports in Europe located inside a major city.

BUS

From the Airport take Buses 783 or 744, walk to the Entrecampos roundabout, Turn to Av. das Forças Armadas, go up approximately 150m and you will find the entrance to the ISCTE – Instituto Universitário de Lisboa on your right handside.

Other lines:
Bus nr. 701 (Campo Grande - Campo Ourique)
Bus nr. 732 (Hospital Sta Maria - Caselas)
Bus nr. 754 (Campo Pequeno - Alfragide)



TAXI or UBER

To get to Iscte it is both simpler and faster to take a taxi.

There are two taxi stands within the perimeter of the airport, one at arrivals and the other at departures: we suggest you take one at the departures stand.

The trip takes about 10 minutes.

Underground / subway train

The Iscte campus station is **Entrecampos** on the yellow line. Exit the station Entrecampos on Av. da República and walk approximately 150m towards the Entrecampos roundabout. Turn left (Av. das Forças Armadas), go up approximately 150m and you will find the entrance to the ISCTE – Instituto Universitário de Lisboa on your right handside.

The Lisbon Airport has a Metro (subway) station with a direct line to the city centre, Red line. You can change at Saldanha to the yellow line (direction Odivelas). It will take you about 30 minutes to get to Iscte.

You must purchase the 'Viva Viagem' electronic travel card. With “zapping” option you can top up with balance for your journeys that can be used both for the Metro and for Carris (bus network):

Viva Viagem electronic card: €0.50 (price in this moment)

Single Fare Price: €1.50 (price in this moment)

<http://metro.transporteslisboa.pt/>

